

KG-3022M

AHD 720P IR Rear view camera



Specifications

Sensor Chip	1/3" SONY IMX225 CMOS
Effective Pixel	1280 (H) x 960 (V)
Scanning System	Progressive scan RGB CMOS
Sensitivity	0 Lux (IR ON)
Infrared Ray LED	12 pcs
Synchronizing System	Internal Sync.
Mirror	Yes
Auto Gain Control	AUTO
Backlight Compensation	AUTO
Noisy Reduction	3D
S/N Ratio	More than 45dB (AGC OFF)
Gamma Compensation	0.45
Electronic Shutter	Auto 【 1/60(50)~1/110,000 】
Video Output	AHD 1.0Vp-p75Ω
Lens Mount	2.5mm megapixel lens
Waterproof	IP67
Adjusting Degree	Pan +/- 60 degree ; Tilt +/- 20 degree
Power Consumption	DC 9~18V / 150mA (LED on)
Dimension / Weight	110 x 67 x 60 mm / 257g
Operating Temperature	-25°C ~ +60°C

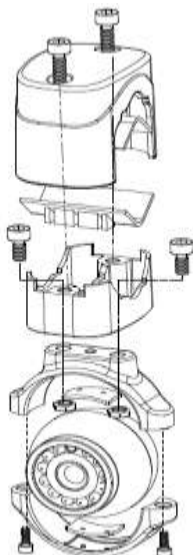

- Input voltage exceeding the nominal rating by over +/-10% will cause abnormal operation

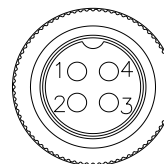

1---12VDC (+)
2---12VDC/GND
3---N/A
4---Video

**Specifications are subject to change without prior notice.*